

## ⚠ WARNING Electrical Shock Hazard

Death or serious injury can result from failure to follow these instructions.

- Service by a qualified service technician only.
- Disconnect power before servicing this product.
- Reconnect all grounding devices after service.
- Replace all parts and panels before operating.

• This machine must be electrically grounded through the grounding lead in the 3-prong power cord. The cord must be plugged into a properly installed and grounded appliance outlet. If local codes require an additional ground connection, use an 14-gauge or larger wire to connect the washer cabinet to an established ground. In all cases the grounding method must comply with all local codes and ordinances.

## ⚠ AVERTISSEMENT Risque de choc électrique

Vous pouvez être tué ou gravement blessé si vous ne suivez pas ces instructions.

- Réparations seulement par un technicien qualifié.
- Débranchez l'alimentation électrique avant la réparation.
- Rebranchez tous les dispositifs de mise à la terre après la réparation.
- Remettez toutes les pièces et panneaux en place avant d'utiliser l'appareil.

• Cette machine doit être mise à la terre par la broche de mise à la terre du cordon d'alimentation à 3 broches. Le cordon doit être branché dans une prise d'alimentation pour un appareil électroménager correctement installée et mise à la terre. Si les codes locaux demandent une connexion de mise à la terre supplémentaire, utilisez un fil de calibre 14 ou supérieur pour connecter le cabinet de la laveuse à une mise à la terre établie. Dans tous les cas, la méthode de mise à la terre doit être conforme à tous les codes et ordonnances locaux.

## ⚠ ADVERTENCIA Riesgo de Descarga Eléctrica

Usted puede morir o sufrir lesiones graves si no sigue estas instrucciones.

- El servicio técnico sólo debe ser realizado por un técnico calificado.
- Desconecte el suministro de corriente antes de realizar el servicio técnico.
- Luego del servicio técnico, vuelva a conectar todos los dispositivos de conexión a tierra.
- Reemplace todas las piezas y paneles antes de utilizar.

• Esta máquina debe estar conectada a tierra a través de una clavija de conexión a tierra del cable de alimentación de 3 clavijas. El cable debe estar enchufado en un tomacorriente para un aparato electrodoméstico correctamente instalado y conectado a tierra. Si los códigos locales requieren una conexión a tierra adicional, utilice un cable de calibre 14 o mayor para conectar el gabinete de la lavadora a una conexión a tierra establecida. En todos los casos, el método de puesta a tierra debe cumplir con todos los códigos y ordenanzas locales.

## Entry into Consumer Error Mode (CEM)

- While the machine is in IDLE STATE ONLY (all LEDs off), press and hold the Start button for 10 seconds.
- After holding the Start button for 10 seconds, all LEDs will turn on, signifying you may release the Start button and the control will boot into CEM.

## Behaviors While In Consumer Error Mode (CEM)

- First fault, if present, will blink on the display using binary code.
- Pressing the Start button will display the next fault code in binary by blinking the status LEDs.
- All status LEDs will blink if:
  - The end of the fault buffer has been reached
  - No faults are present

## Exiting Consumer Error Mode (CEM)

- Pressing any button (other than Start) or turning any knob will exit Consumer Error Mode.
- Consumer Error Mode will time out after 10 minutes.

## ① To Remove Front Panel:

1. Locate the two front spring dips between the top cover and the front panel, by inserting a putty knife about 4-1/8" from each side of cabinet (see illustration).
2. Push putty knife in to release clip on both sides.
3. Rotate the front panel forward and lift off the cabinet base locating tabs.
4. Reverse procedure to reassemble.

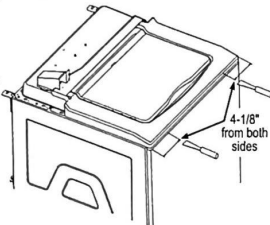

## ② To Remove Cover/Lid Assembly:

1. Remove front panel using step ①.
2. Remove two 1/4" hex screws on front of cabinet.
3. Reach under the lid assembly and locate lid switch. Squeeze lid switch latch in to release while gently pushing it upward. Guide lid switch through opening.
4. Remove lid lock by removing two Phillips #2 screws located at left side of cover recess.
5. Disconnect lid lock harness from top cover. **NOTE: Do NOT cut the black wire tie. As needed, remove and reinstall it.**
6. Remove cover/lid assembly.
7. Reverse procedure to reassemble.

## ③ To Remove Spin Basket:

1. Drain all water from tub by turning on washer to Drain & Spin cycle.
2. Complete steps ① and ②.
3. Disconnect drive harness and pressure switch hose (release all wire ties).
4. Disengage the water valve mounting plate from the cabinet by removing two 1/4" hex head screws.

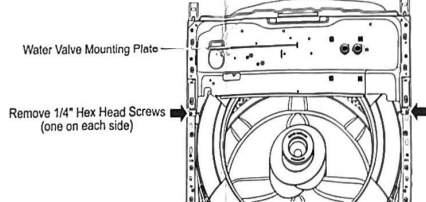

5. Remove tub cover by lifting tabs on tub cover and pull off. Locate alignment tabs on tub for reassembly.
6. Remove 7/16" hex bolt attaching agitator to spline shaft.
7. Remove agitator by lifting it straight up and off the shaft.
8. Remove left-handed 1-5/16" hub nut. **NOTE: This nut is aluminum so take care not to round the edges when removing or replacing.**
9. Disconnect drain hose inlet (black hose) from bottom of tub.
10. Remove front rod and spring assembly (one at a time) by lifting tub assembly to take weight off suspension spring at lower portion of rod. Pull the spring assembly out of the tub leg and repeat for rear rod and spring assemblies. Allow them to hang freely. **NOTE: The front rod and spring assemblies are color coded according to spring color and should not be switched.**

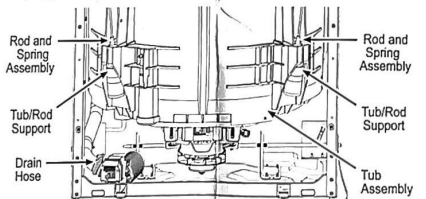

11. The tub assembly will now lean forward after both front rod and spring assemblies are unhooked at tub supports.
12. Lift and push the tub/drive assembly bottom towards the rear of the cabinet and pull the top of tub out under top lip of cabinet.

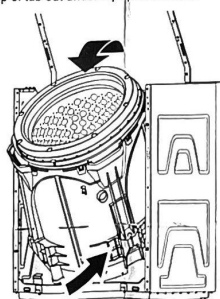

13. Pull basket out of tub by lifting it out as shown below.

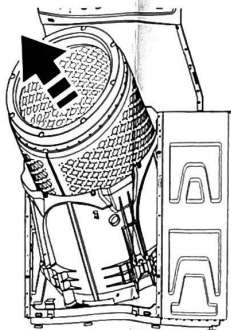

14. Reverse procedure for reassembly.

## ④ To Service Motor:

1. Complete step ①.
2. Remove belt by pushing down on belt near motor pulley while turning large pulley.
3. Disconnect wire harness to motor and speed sensor.
4. Remove two 1/2" hex motor bolts and pull out (the motor shield will be loose at this time).

## To Reinstall Motor:

1. Set top shield, motor, motor grommets, motor brackets and hand-start the two motor bolts.
2. Attach belt to motor pulley and rotate large pulley until the belt slack is taken up.
3. Pull motor until belt tension (8-11 lbs) is properly set and tighten motor bolts.
4. Reconnect motor power and speed sensor connectors up until tabs are fully seated and place wire tie.
5. Reverse procedure to reassemble.
6. Put the machine on Drain & Spin cycle, close lid then the control will pulse the lid lock and lock the lid.
7. The machine will start to drain and the spin will start after some seconds. Let the spin run and pause unit.
8. After the basket stops the lid lock will be release.

## ⑤ To Service Tub:

1. Complete steps ①, ② and ③.
2. Remove 3/8" hex bolts attaching drive assembly to tub (16 bolts for 27" wide stack unit and 14 bolts for 24" wide stack unit).
3. Disconnect over flow hose (black hose) at wall tub.
4. Place a new main seal on drive system before reassembling tub, clean tub surface, set the seal in a way to avoid damages with basket shaft.
5. Reverse procedure to reassembly.

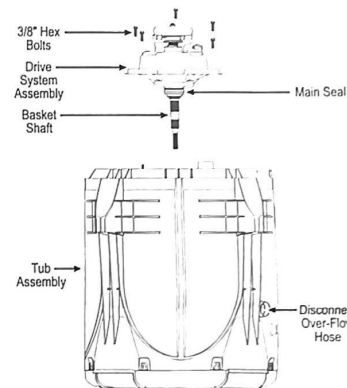

## ⑥ To Remove Transmission:

1. Complete steps ①, ② and ③.
2. Remove belt by pushing up on belt near motor pulley while turning large pulley.
3. Remove two 1/2" hex motor bolt and pull out (the motor shield will be loose at this time).
4. Remove large pulley by holding pulley with one hand and removing 5/8" hex nut.
5. After pulley is removed, remove two 3/8" hex bolts on shifter assembly.
6. Shifter and shifter spring will be loose at this time.
7. Remove two 1/2" hex bolts from package bracket.
8. Place a new main seal on drive system before reassembly on tub.
9. Reverse procedure to reassembly.

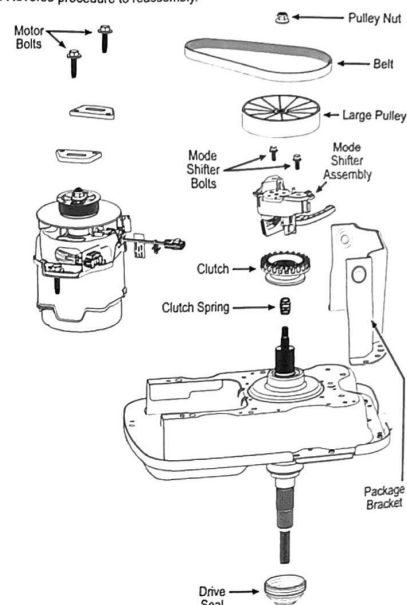

Fault Code	Name
1	Lid Mallock
2	Lid Mallock
3	Lid Lock Sensor Mallock
5	Motor Mallock
6	Critical Front Level by Pressure Pressure level exceeds 11.5" above pressure port
8	Pressure Sensor Loss
9	Lid Lock Malfunction
10	Motor Mallock
12	Redundant Front Condenser
13	Redundant Lid Unlocked
15	Water Temp Sensor Invalid
17	Dry Load Sense Timeout
18	Drain Pump Clearing agitator failed
19	UI State Timeout
20	Critical Flood Level by Gallons
22	Out of Balance (OOB) during Dry Load Sense
23	Critical Lid Lock Failure
24	Lid Logic Failure
25	Pressure Sensor Dropout
26	Out of Balance (OOB) Ended Final Spin
27	Water Accessibility
28	Options Knobs Feedback Invalid
29	Switch Lock Abatement Failure
30	Start Button Fault
31	Out of Balance (OOB) Falback in Final Spin
32	Critical Lid Lock Failure Can't Unlock Lid

Fault # displayed on 5 segment display
1
2
3
5
8
8
9

31-3000107

31-3000107

31-3000107



31-3000107

31-3000107

31-3000107

**⚠ WARNING Electrical Shock Hazard**  
 Death or serious injury can result from failure to follow these instructions.  
 • Service by a qualified service technician only.  
 • Disconnect power before servicing this product.  
 • Reconnect all grounding devices after service.  
 • Replace all parts and panels before operating.

**⚠ AVERTISSEMENT Risque de choc électrique**  
 Vous pouvez être tué ou gravement blessé si vous ne suivez pas ces instructions.  
 • Réparations seulement par un technicien qualifié.  
 • Débranchez l'alimentation électrique avant la réparation.  
 • Rebranchez tous les dispositifs de mise à la terre après la réparation.  
 • Remettez toutes les pièces et panneaux en place avant d'utiliser l'appareil.

**⚠ ADVERTENCIA Riesgo de Descarga Eléctrica**  
 Usted puede morir o sufrir lesiones graves si no siguen estas instrucciones.  
 • El servicio técnico sólo debe ser realizado por un técnico calificado.  
 • Desconecte el suministro de corriente antes de realizar el servicio técnico.  
 • Luego del servicio técnico, vuelva a conectar todos los dispositivos de conexión a tierra.  
 • Reemplace todas las piezas y paneles antes de utilizar.

**AIR FLOW AND SEALS**

Proper air flow through the dryer is essential for normal operation of the temperature control and safety systems. Air is PULLED into the cabinet from rear and drawn up across the heaters located behind the drum. This hot air is PULLED through the drum rear, across the clothes load, through the lint trap and down the trap duct into the blower. From the blower the air is PUSHED out of the exhaust system. Any air leaks between the air inlet and the blower, such as lower drum front left or trap duct to cabinet front sealing, will result in improper temperatures. The air being pulled down the trap duct to the drum outlet thermostat will be cooler than normal, giving this thermostat a false indication (delayed or no-trip). Leaks ahead of the blower will also reduce the volume of air across the heaters causing hot spots and possible premature failure.

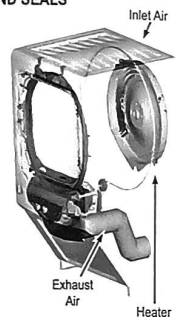

**TRAP DUCT SEALING**

To inspect the trap duct for proper sealing, remove the lint filter and look down into the duct. With a light examine the trap duct on all sides where it meets the dryer front for voids in sealing. Leaks may be sealed with permagum.  
 • WHEN FLEXIBLE DUCT IS USED, WE STRONGLY RECOMMEND METALLIC FLEXIBLE DUCT.  
 • EXHAUST DUCT MUST BE 100mm (4 INCH) DIAMETER  
 • FOR SPECIFIC EXHAUST SPECIFICATION, REFER TO INSTALLATION INSTRUCTIONS SUPPLIED WITH THE DRYER.

**DRIVE BELT**

The drum is rotated counterclockwise, as viewed from the front, at a speed of 47-51 RPM. Belt tension is maintained by a spring-loaded idler pulley and driven by a pulley attached to the rear motor shaft.



**SERVICE PARTS AND LUBRICATION**

- Motor & Pulley (24" models) 115V-60Hz..... WE17X22214
- Motor & Pulley (27" models) 115V-60Hz..... WE49X27320
- Drive Belt (24" models)..... WE12M151
- Drive Belt (27" models)..... WE12M29
- Idler Arm..... WE12M50
- Drum Bearing Sleeve..... WE1M462
- Blower Wheel..... WE16X20393
- Grease - Idler Bearing..... WE25X46

**LONG VENT MODELS ONLY:**  
 Motor & Pulley (27" LV models) 115V-60Hz..... WE49X27321  
 Idler Arm (LV models)..... WE03X27283

**SERVICE NOTE:**  
 Some replacement parts may have more terminal connections than the original part. Wire the new part to the same numbered terminals as the original part and disregard the unused terminals unless a special instruction is provided.

**WIRING DIAGRAM**

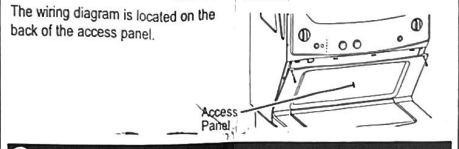

The wiring diagram is located on the back of the access panel.  
**1 To Remove Access Panel:**  
 1. Remove two screws at top left and right corners of the access panel.  
 2. Lift slightly, pull straight out and tilt the panel down. The wiring diagram is mounted to the access panel.

**2 To Remove Heat Shield & Connectors:**  
 • To unplug the connectors, remove the two screws in the middle of the heat shield and pull it straight out.

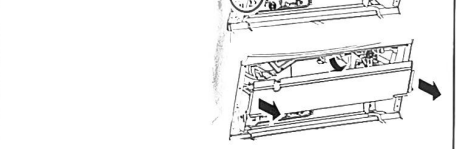

**3 To Remove Control Panel:**  
 • Unscrew the screws around the control panel (open the door to see some). Pull straight out slightly on the control panel to remove the dryer knob, remove the dryer knob and remove the control panel.

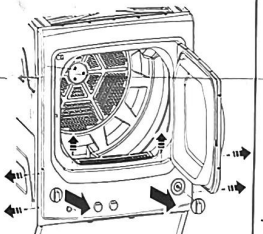

**4 To Remove Front Panel:**  
 • Remove the front panel mounting screws - 4 screws near the bottom and 3 screws on the top.  
 • Lift the front panel up, to release the mounting clips, and then remove it.

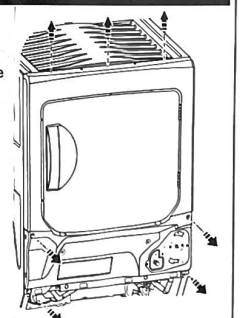

**5 To Remove Drum:**  
 Service procedure: After removing the front panel, move the idler pulley to the bracket motor to lock it, so you can loosen the belt. Once belt is loosened and moved off the motor pulley, slightly lift and pull out the drum.  
 Reassemble note: Re-route the belt on the motor and idler pulley, then release the idler from the motor bracket. Be sure that the belt is correctly routed on the idler pulley and motor pulley. Slowly turn the drum by hand counter-clockwise to ensure belt is aligned and not twisted. Drum RPM should be between 45-55 after re-assembly of the front panel. Verify that the slides on the top bearing are in the correct position.

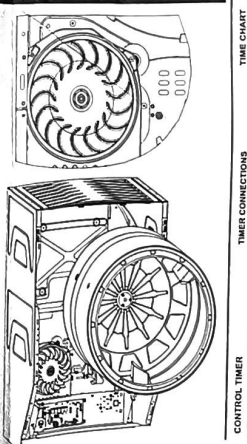

**ELECTRIC**

**6 For Long Vent Models Only:**

1. Belt removal: Grasp the pulley, force it to the left 1" to 2" and hook the pulley shaft on the bracket idler arm ensuring that the cap nut assembly is behind the bracket.

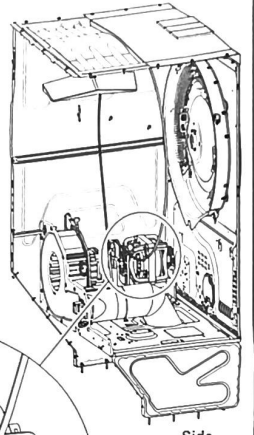

2. Long vent: Idler arm hooked.

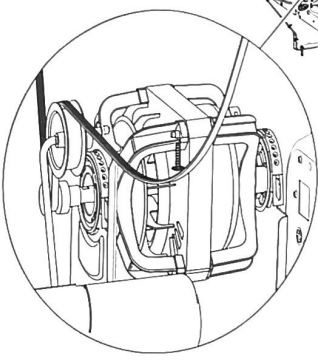

3. Belt re-location: The belt must be placed and run in the back groove position for both normal and long vent models.

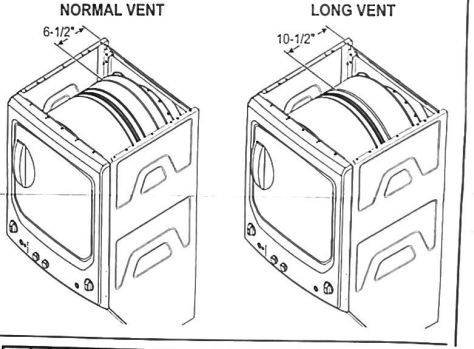

TIME CHART		TEMPERATURE °F		TEMPERATURE °C	
TIME	TEMPERATURE °F	TEMPERATURE °C	TEMPERATURE °F	TEMPERATURE °C	TEMPERATURE °F
300 ± 270 MIN	120 ± 5	110	120 ± 5	110	120 ± 5
DRUM OUTLET (LONG VENT ONLY)	130 ± 5	120 ± 5	130 ± 5	120 ± 5	130 ± 5
DRUM OUTLET (LONG VENT ONLY)	145 ± 5	135 ± 5	145 ± 5	135 ± 5	145 ± 5
CONTROL INLET (27" MODELS)	155 ± 5	145 ± 5	155 ± 5	145 ± 5	155 ± 5
CONTROL INLET (LONG VENT ONLY)	165 ± 5	155 ± 5	165 ± 5	155 ± 5	165 ± 5
SAFETY (LONG VENT ONLY)	215 ± 5	205 ± 5	215 ± 5	205 ± 5	215 ± 5
SAFETY (LONG VENT ONLY)	225 ± 5	215 ± 5	225 ± 5	215 ± 5	225 ± 5
HIGH LIMIT	305 ± 5	295 ± 5	305 ± 5	295 ± 5	305 ± 5

WINDINGS & COILS RESISTANCE VALUES	
MANDRUM MOTOR	START 2.8T ± 0.3
MANDRUM MOTOR	RUN 3.10 - 3.33
BLOWER MOTOR	INNER 14.25 - 15.75
BLOWER MOTOR	OUTER 23.70 - 26.00
HEATER COILS 27"	INNER 23.70 - 26.00
HEATER COILS 27"	OUTER 28.20 - 33.00
HEATER COILS 24"	INNER 23.70 - 26.00
HEATER COILS 24"	OUTER 28.20 - 33.00
TIMER MOTOR	3384 - 3810
INLET & OUTLET	9K

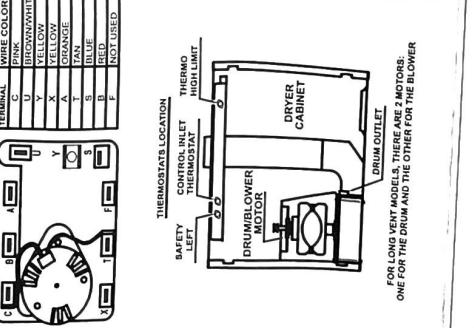

GUD27ESSMIWW



Electric D. Dryer

# RYER & UNITED LAUNDRY CENTER APPLIANCE WIRING DIAGRAM

## Washer

**CAUTION:** Label all wires prior to disconnection when servicing controls. Wiring errors can cause improper and dangerous operation. Verify proper operation after servicing.

Terminal	Wiring	Pressure Sensor
1	Not usable	5. Not usable
2	Power supply	6. Not usable
3	Ground	7. Not usable
4	Output	8. Not usable

NOTE: To ensure correct voltage, connect the probe between pins 4 and pin 3. Shorting pins 3 to pin 2 will drain the main board to shut down.

Resistance Table	Temp (C)	Temp (F)	Resistance (Ω)
10	50	122	0.39
20	60	140	0.46
30	86	187	0.77
40	104	217	1.24
50	122	252	1.92
60	140	284	2.88
70	158	316	4.42
80	176	347	6.74
90	194	371	10.12
100	212	404	15.12
110	230	436	22.42
120	248	468	33.62
130	266	500	50.42
140	284	532	75.12
150	302	564	110.42
160	320	596	163.12
170	338	628	239.12
180	356	660	351.12
190	374	692	513.12
200	392	724	751.12
210	410	756	1091.12
220	428	788	1581.12
230	446	820	2281.12
240	464	852	3361.12
250	482	884	4961.12
260	500	916	7241.12
270	518	948	10441.12
280	536	980	15041.12
290	554	1012	21641.12
300	572	1044	31241.12
310	590	1076	45441.12
320	608	1108	65641.12
330	626	1140	94441.12
340	644	1172	134441.12
350	662	1204	191441.12
360	680	1236	271441.12
370	698	1268	381441.12
380	716	1300	528441.12
390	734	1332	728441.12
400	752	1364	996441.12
410	770	1396	1356441.12
420	788	1428	184441.12
430	806	1460	251441.12
440	824	1492	344441.12
450	842	1524	471441.12
460	860	1556	638441.12
470	878	1588	864441.12
480	896	1620	116441.12
490	914	1652	156441.12
500	932	1684	209441.12
510	950	1716	281441.12
520	968	1748	378441.12
530	986	1780	508441.12
540	1004	1812	681441.12
550	1022	1844	898441.12
560	1040	1876	116441.12
570	1058	1908	150441.12
580	1076	1940	194441.12
590	1094	1972	250441.12
600	1112	2004	321441.12
610	1130	2036	409441.12
620	1148	2068	518441.12
630	1166	2100	652441.12
640	1184	2132	816441.12
650	1202	2164	101441.12
660	1220	2196	125441.12
670	1238	2228	154441.12
680	1256	2260	189441.12
690	1274	2292	231441.12
700	1292	2324	281441.12
710	1310	2356	341441.12
720	1328	2388	414441.12
730	1346	2420	502441.12
740	1364	2452	608441.12
750	1382	2484	736441.12
760	1400	2516	888441.12
770	1418	2548	1068441.12
780	1436	2580	1288441.12
790	1454	2612	155441.12
800	1472	2644	187441.12
810	1490	2676	225441.12
820	1508	2708	270441.12
830	1526	2740	324441.12
840	1544	2772	388441.12
850	1562	2804	464441.12
860	1580	2836	554441.12
870	1598	2868	660441.12
880	1616	2900	784441.12
890	1634	2932	928441.12
900	1652	2964	109441.12
910	1670	2996	128441.12
920	1688	3028	1498441.12
930	1706	3060	174441.12
940	1724	3092	202441.12
950	1742	3124	234441.12
960	1760	3156	270441.12
970	1778	3188	311441.12
980	1796	3220	358441.12
990	1814	3252	411441.12
1000	1832	3284	471441.12

Resistance Table	Temp (C)	Temp (F)	Resistance (Ω)
10	50	122	0.39
20	60	140	0.46
30	86	187	0.77
40	104	217	1.24
50	122	252	1.92
60	140	284	2.88
70	158	316	4.42
80	176	347	6.74
90	194	371	10.12
100	212	404	15.12
110	230	436	22.42
120	248	468	33.62
130	266	500	50.42
140	284	532	75.12
150	302	564	110.42
160	320	596	163.12
170	338	628	239.12
180	356	660	351.12
190	374	692	513.12
200	392	724	751.12
210	410	756	1091.12
220	428	788	1581.12
230	446	820	2281.12
240	464	852	3361.12
250	482	884	4961.12
260	500	916	7241.12
270	518	948	10441.12
280	536	980	15041.12
290	554	1012	21641.12
300	572	1044	31241.12
310	590	1076	45441.12
320	608	1108	65641.12
330	626	1140	94441.12
340	644	1172	134441.12
350	662	1204	191441.12
360	680	1236	271441.12
370	698	1268	381441.12
380	716	1300	528441.12
390	734	1332	728441.12
400	752	1364	996441.12
410	770	1396	1356441.12
420	788	1428	184441.12
430	806	1460	250441.12
440	824	1492	344441.12
450	842	1524	471441.12
460	860	1556	638441.12
470	878	1588	864441.12
480	896	1620	116441.12
490	914	1652	156441.12
500	932	1684	216441.12
510	950	1716	296441.12
520	968	1748	396441.12
530	986	1780	524441.12
540	1004	1812	684441.12
550	1022	1844	874441.12
560	1040	1876	110441.12
570	1058	1908	139441.12
580	1076	1940	174441.12
590	1094	1972	216441.12
600	1112	2004	266441.12
610	1130	2036	326441.12
620	1148	2068	396441.12
630	1166	2100	476441.12
640	1184	2132	566441.12
650	1202	2164	666441.12
660	1220	2196	786441.12
670	1238	2228	926441.12
680	1256	2260	1086441.12
690	1274	2292	1266441.12
700	1292	2324	1466441.12
710	1310	2356	1686441.12
720	1328	2388	1926441.12
730	1346	2420	2186441.12
740	1364	2452	2466441.12
750	1382	2484	2766441.12
760	1400	2516	3096441.12
770	1418	2548	3456441.12
780	1436	2580	3846441.12
790	1454	2612	4266441.12
800	1472	2644	4716441.12
810	1490	2676	5196441.12
820	1508	2708	5706441.12
830	1526	2740	6246441.12
840	1544	2772	6816441.12
850	1562	2804	7416441.12
860	1580	2836	8046441.12
870	1598	2868	8706441.12
880	1616	2900	9396441.12
890	1634	2932	10116441.12
900	1652	2964	10866441.12
910	1670	2996	11646441.12
920	1688	3028	12466441.12
930	1706	3060	13316441.12
940	1724	3092	14196441.12
950	1742	3124	15106441.12
960	1760	3156	16046441.12
970	1778	3188	17016441.12
980	1796	3220	18016441.12
990	1814	3252	19046441.12
1000	1832	3284	20106441.12

Resistance Table	Temp (C)	Temp (F)	Resistance (Ω)
10	50	122	0.39
20	60	140	0.46
30	86	187	0.77
40	104	217	1.24
50	122	252	1.92
60	140	284	2.88
70	158	316	4.42
80	176	347	6.74
90	194	371	10.12
100	212	404	15.12
110	230	436	22.42
120	248	468	33.62
130	266	500	50.42
140	284	532	75.12
150	302	564	110.42
160	320	596	163.12
170	338	628	239.12
180	356	660	351.12
190	374	692	513.12
200	392	724	751.12
210	410	756	1091.12
220	428	788	1581.12
230	446	820	2281.12
240	464	852	3361.12
250	482	884	4961.12
260	500	916	7241.12
270	518	948	10441.12
280	536	980	15041.12
290	554	1012	21641.12
300	572	1044	31241.12
310	590	1076	45441.12
320	608	1108	65641.12
330	626	1140	94441.12
340	644	1172	134441.12
350	662	1204	191441.12
360	680	1236	271441.12
370	698	1268	381441.12
380	716	1300	528441.12
390	734	1332	728441.12
40			